

Sailing yacht Bavaria Cruiser 46 | Emma

Yacht ID:	32	Length:	14.27 m
Yacht type:	Sailing yacht	Production year:	2024
Yacht:	Bavaria Cruiser 46 Emma	Cabins:	4
Marina:	Croatia / Marina Veruda, Pula	Persons:	8 + 1
Mainsail type:	furling/roll	Toilets:	3
Steering type:	2 Steering Wheels	Engine:	1 x 55 hp
Genoa type:	furling/roll	Beam:	4.35 m
Deposit:	2.000,00 €	Draft:	2.10 m

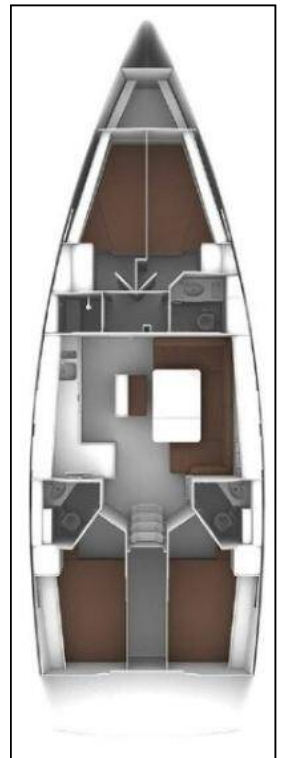

Deck: Bimini top, Cockpit/stern, outside shower, Dinghy, Electric anchor windlass, Sprayhood,

Entertainment: Radio,

Galley: Kitchen utensils (Galley equipment, cutlery),

Interior: Electric toilet,

Navigation: Autopilot, Bow thruster, GPS chart plotter - cockpit, Log, Speed, Depth- echo sounder,

Safety: Black Water Tank,

Yacht electrics: Solar panels,

Availability

16.06. - 20.06.2026 Booked	20.06. - 27.06.2026 2.831 €3.700 €	27.06. - 04.07.2026 3.225 €4.300 €	04.07. - 11.07.2026 3.290 €4.300 €
11.07. - 18.07.2026 3.519 €4.600 €	18.07. - 25.07.2026 3.749 €4.900 €	25.07. - 01.08.2026 3.749 €4.900 €	01.08. - 08.08.2026 Booked
08.08. - 15.08.2026 3.749 €4.900 €	15.08. - 05.09.2026 Booked	05.09. - 12.09.2026 Booked	12.09. - 19.09.2026 Booked
19.09. - 26.09.2026 Booked	26.09. - 03.10.2026 Booked	03.10. - 10.10.2026 1.760 €2.300 €	10.10. - 17.10.2026 Booked
17.10. - 24.10.2026 1.760 €2.300 €	24.10. - 31.10.2026 1.760 €2.300 €	31.10. - 07.11.2026 1.760 €2.300 €	07.11. - 14.11.2026 1.760 €2.300 €
14.11. - 21.11.2026 1.760 €2.300 €	22.11. - 13.03.2027 Booked		